

## 9. HAND OPERATED PUMPS

### 9.1 HANDPUMP SPECIFICATIONS

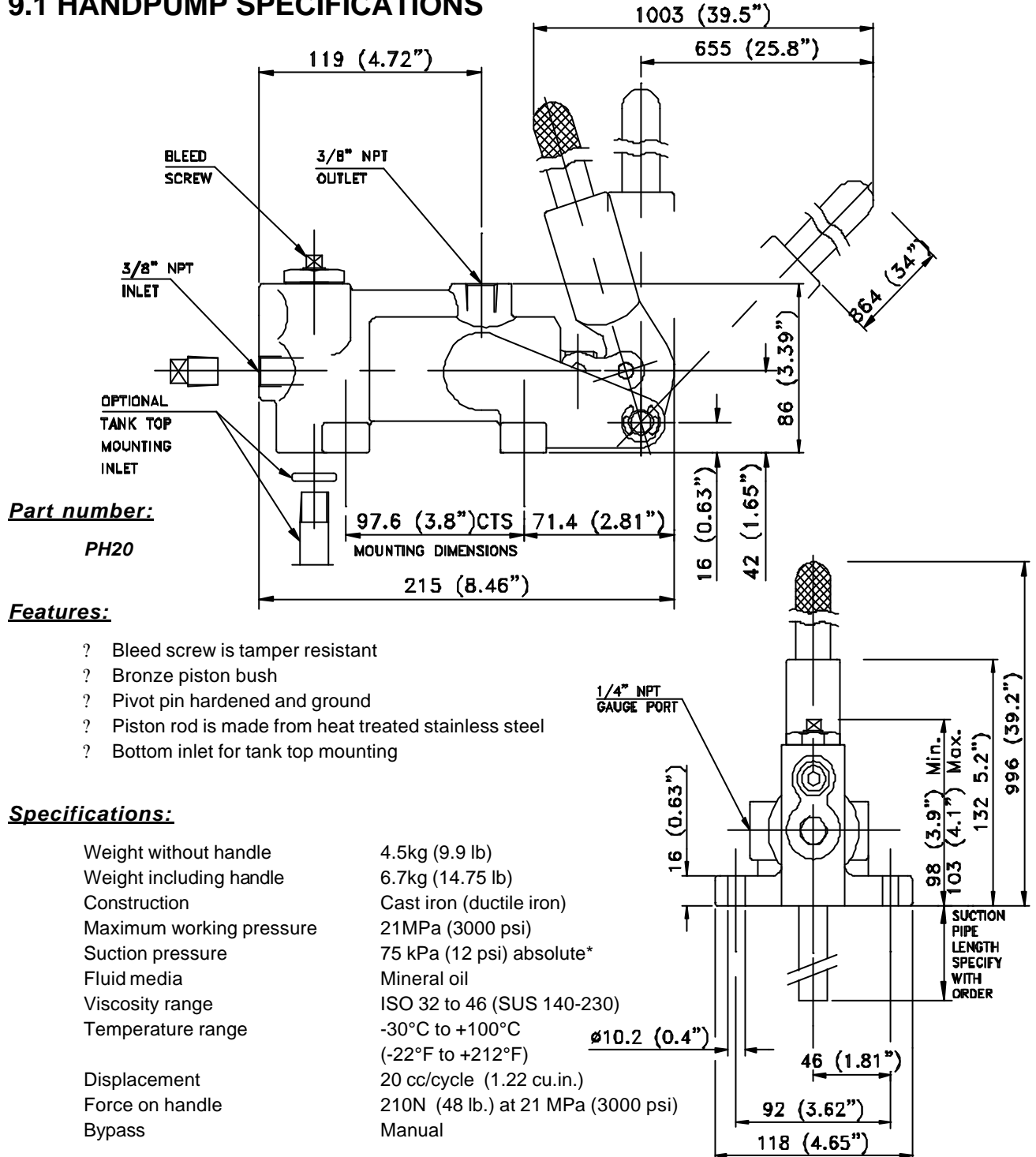

\* This equates to the pump operating (priming) 3m (9.8 ft) above oil level at sea level altitude.

Specifications are subject to change without prior notice due to product improvements.

## 9.2 HANDPUMP PARTS LIST

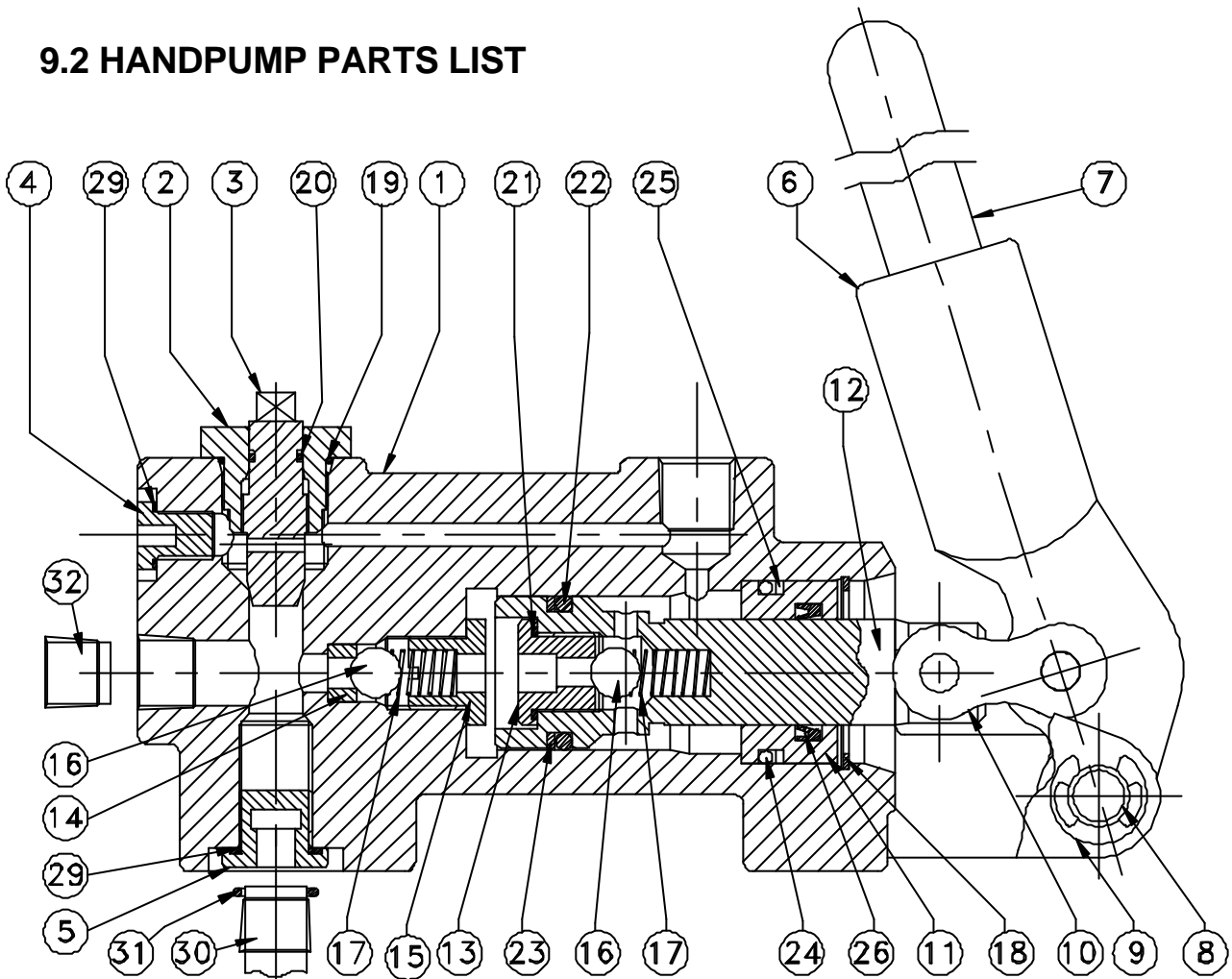

Item	Description	Qty	Part no.	Item	Description	Qty	Part no.
1	Pump body	1	PH20-01	16	Valve ball	2	PH20-16
2	Guide bush	1	PH20-02	17	Valve spring	2	PH20-17
3	Bleed screw	1	PH20-03	18	Circlip (piston bush)	1	PH20-18
4	Bleed plug	1	PH20-04	19	O-ring (guide bush)	1	PH20-19
5	Tank top plug	1	PH20-05	20	O-ring (bleed screw)	1	PH20-20
6	Pivot lever	1	PH20-06	21	Seal (outlet valve seat)	2	PH20-21
7	Handle	1	PH20-07	22	O-ring (piston)	1	PH20-22
8	Pivot pin	1	PH20-08	23	Backup ring (piston)	1	PH20-23
9	Circlip	2	PH20-09	24	O-ring (bush)	1	PH20-24
10	Connecting link	1	PH20-10	25	Backup ring (bush)	1	PH20-25
11	Piston bush	1	PH20-11	26	U-seal	1	PH20-26
12	Piston	1	PH20-12	29	Seal ring	1	PH20-29
13	Outlet valve seat	1	PH20-13	30	Standpipe (optional)	1	PH20-30
14	Inlet valve seat	1	PH20-14	31	O-ring (standpipe)	1	PH20-31
15	Inlet spring retainer	1	PH20-15	32	Plug	1	PH20-32

Items 16 to 29 included in repair kit PH20-RK

Specifications are subject to change without prior notice due to product improvements.